

ULSTER COUNTY EXECUTIVE

244 Fair St., P.O. Box 1800, Kingston, New York 12402

Telephone: 845-340-3800

Fax: 845-334-5724

JEN METZGER

County Executive

CHRISTOPHER KELLY

Deputy County Executive

Chief of Staff

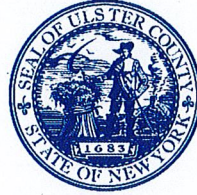

JOHANNA CONTRERAS

Deputy County Executive

AMANDA LAVALLE

Deputy County Executive

May 5, 2023

Neil Bettez Supervisor
Timothy Rogers, Mayor

Re: Water Supply Ulster County Government Operation Center

Dear Supervisor and Mayor,

I am writing with respect to Ulster County proposed Government Operation Center (GOC) to be located on Paradies Lane in the Town of New Paltz. As you are aware, Ulster County is proposing to establish a GOC at the Paradies Lane site and we have entered into a purchase and sale agreement with the current owner. As part of our design process, we have explored alternatives for providing water to the facility. While there is available water on-site, the use of municipal water offers a preferable option providing assurance of supply and the ability to meet fire flow demands.

The County estimates that normal daily use at the facility would not exceed 1,500 GPD.

The current Town district now has an 8" line that extends across the Thruway main line and terminates near the existing Park-and-Ride facility. Ulster County is proposing to extend that line under the existing Thruway access ramp to the project site. We have engaged the Thruway in discussions concerning the necessary easements to accomplish this and they are amenable at this point.

Ulster County is requesting assurances, hopefully in the form of resolutions, from the Village and Town that there is support for providing water to the facility.

There are, in our opinion, two (2) possible ways forward to allow this to occur should you agree:

1. Out-of-District User: This would entail an agreement by all parties to provide water to the GOC as an out-of-district user with the extension of the existing line at the Park-and-Ride to the site. The County would pay for the construction of this line and would own the line with both the ability to allow other users to tap the line with Town approval. A maintenance agreement with the town water department would be included. In the alternative, the County would turn the line over to the town upon completion taking the necessary easements to ensure our ability to use the line and allowing us to bond the cost; and

2. Extension of Existing District: This option would provide for the extension of the existing district to encompass the area being utilized by the Project rather than the entire site at this time. The County would develop the needed Map Plan and Report as required for a district extension. Ownership options would be similar to the above

The NYCDEP would be involved in either option. We have had informal discussions with them on this issue and they would be willing to supply the water to the Project.

If you are amenable, I would suggest that the project team meet with the necessary officials and boards to discuss the water supply alternatives in more detail.

I have attached the current district and water line location as well as the latest project site plan to further inform a decision.

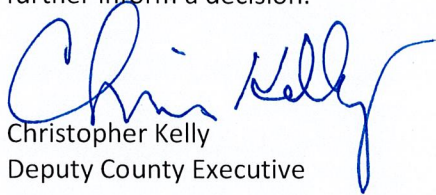
Christopher Kelly
Deputy County Executive

Cc: Dennis Doyle, Planning
Everett Erichsen, Emergency Management
Paul Rush, NYCDEP

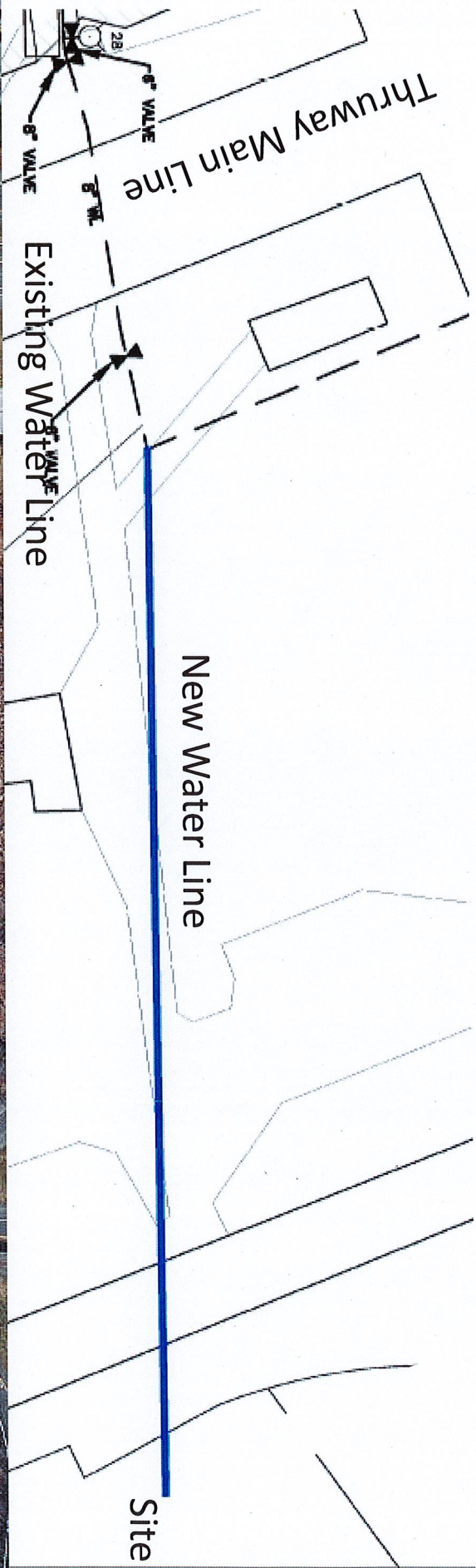

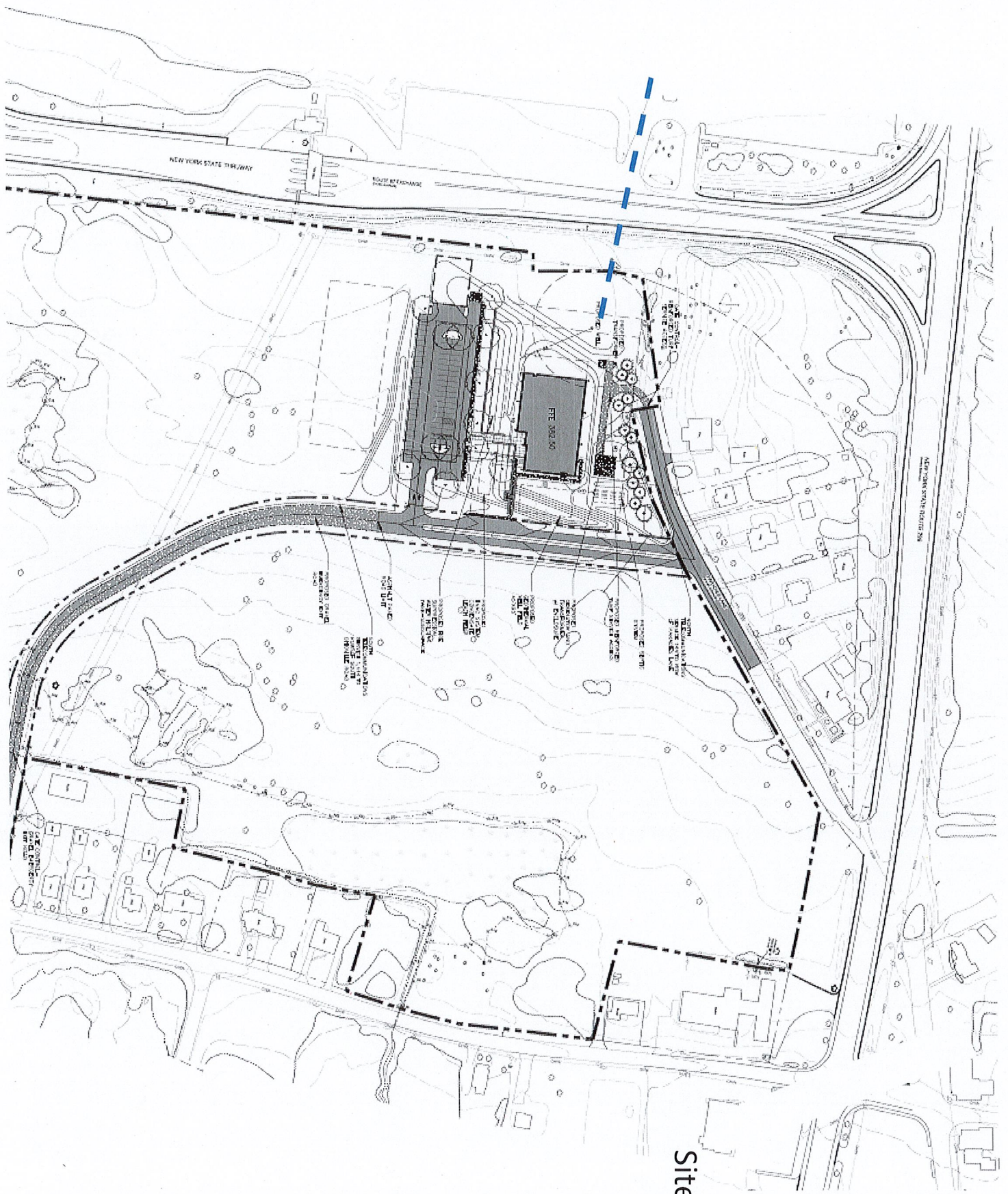

NEW YORK STATE THRUWAY

SOUTH BY EXCHANGE

NEW YORK STATE ROUTE 28

FTE 300.00

PROPOSED 100' WIDE

CONCRETE

PAVING

CONCRETE

PAVING

CONCRETE

PAVING

CONCRETE

PAVING

CONCRETE

PAVING

CONCRETE

PAVING

CONCRETE

PAVING

CONCRETE

PAVING

CONCRETE

PAVING

CONCRETE

PAVING

EXISTING

CONCRETE

PAVING

CONCRETE

PAVING

CONCRETE

PAVING

CONCRETE

PAVING

CONCRETE

PAVING

CONCRETE

Site

New Water Line

SERVICE ACCESS

PROPOSED
TRANSFORMER
#2

FFE 382.50

OHW

OHW

OHW

